

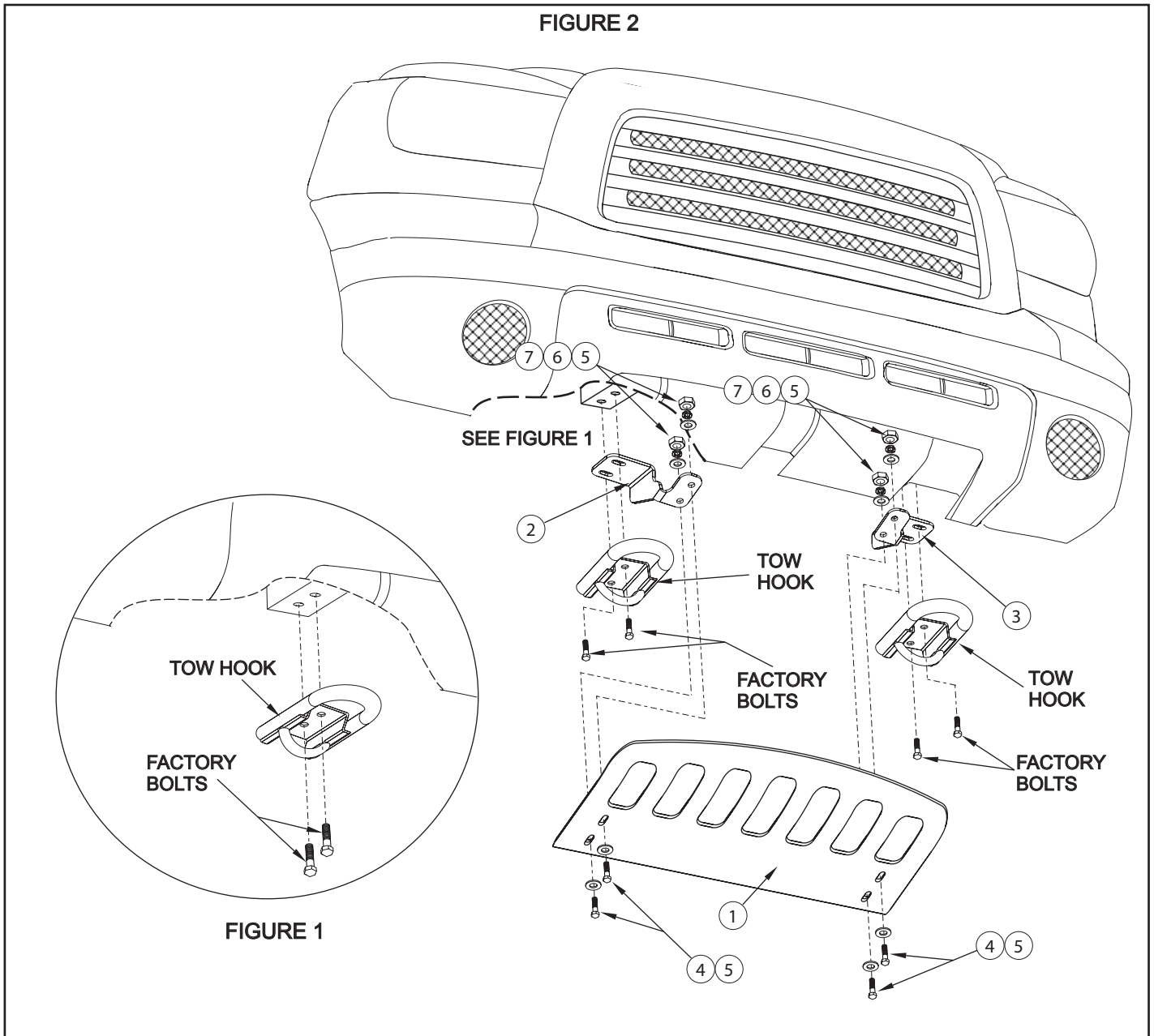

- STEP 1. Remove contents from box and check for damage. Verify all parts are present. Read instructions completely before beginning.
- STEP 2. Locate and remove the M12 bolts securing the tow hooks to the frame. SEE FIGURE 1. Save the M12 fasteners and tow hooks for reinstallation later.
- STEP 3. Install the brackets between the frame and the tow hooks using factory fasteners. Leave loose. SEE FIGURE 2.
- STEP 4. Attach the skid plate to the brackets using the 3/8" fasteners. Leave loose. SEE FIGURE 2. Adjust skid plate and brackets all the way forward to the front of the vehicle to avoid scratching the bumper while tightening the fasteners.
- STEP 5. Level and adjust the skid plate as desired. Torque M12 fasteners to 65 Ft. Lbs and 3/8" fasteners to 35 Ft. Lbs.



Checklist - these points **MUST** be checked to ensure a quality installation.

Check:

Visual check of Skid Plate.

Check gap.

Look For:

Visually centered left to right & level

Gap tolerance should be +/-5mm from side to side.



Re-check all bolts for torque.

Target 65 ft. lbs

Inspection range @ 48 ft. lbs ~ 97 ft. lbs

Target 35 ft. lbs

Inspection range @ 26 ft. lbs ~ 52 ft. lbs

(Both Bolts @ -25% / +50%)

Note: Range provided by QA